



ERASMUS+ PROJECT  
**Re@WBC**

Enhancement of HE research potential  
contributing to further growth of the WB region



Co-funded by the  
Erasmus+ Programme  
of the European Union

**Erasmus + Project No 561586-EPP-1-2015-1-RS-EPPKA2-CBHE-JP  
Enhancement of HE Research Potential Contributing to Further Growth  
of the WB Region**

Ref. No and Title of Workpackage	WP1 Preparation for research potential enhancement
Title of Deliverable:	1.2. Mapping HR management strategies at EU universities
Institution:	Politecnico di Torino
Author/s of the deliverable	M. Demichela, E. Pilone
Status of the document:	Final
Document Version no and date:	v6. 16.03.2016
Number of Pages	5
Dissemination Level	Public

Abstract	Schedule of the project meeting at Politecnico di Torino
----------	--



ERASMUS+ PROJECT  
**Re@WBC**

Enhancement of HE research potential  
contributing to further growth of the WB region



Co-funded by the  
Erasmus+ Programme  
of the European Union

**The meeting will take place from 21st to 25th March in “SALA DENINA”, 1st floor of DISAT DEPARTMENT.**

Please find below a guide and a map to reach the meeting place:

- enter the POLITECNICO main entrance in corso Duca degli Abruzzi no. 24;
- cross the first open yard and enter the glass door on your right;
- turn on your left and step the corridor until its end
- turn to right in another corridor
- after a while, you will find on your left the main entrance for DISAT department
- enter the door and turn to right; you will find a lift and stairs to reach the first floor

Please notice that the entrance to DISAT is admitted only with a dedicated card;  
if you do not succeed to enter or you find the door closed please call:

- Eleonora +39 3393371469
- Micaela +39 3356603029

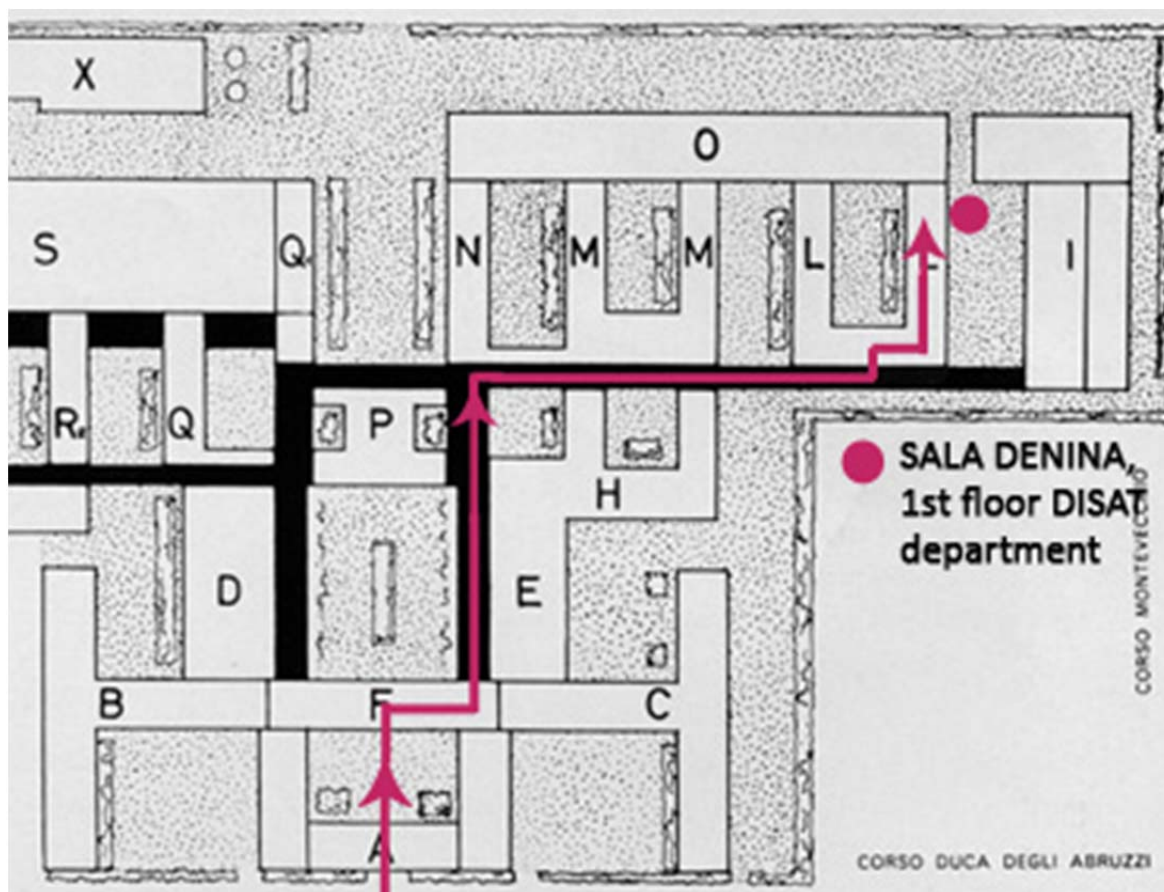



ERASMUS+ PROJECT  
**Re@WBC**

Enhancement of HE research potential  
contributing to further growth of the WB region



Co-funded by the  
Erasmus+ Programme  
of the European Union

21st March – Introductory meetings		
TIME	TOPIC	Reference
Morning	No activities are foreseen	
13-14:30	Lunch	
14.30 – 14.45	Welcome of Vice-Rector for the Internationalization	Prof. Bernardino Chiaia, Vice Rector for the Internationalization
14.45 – 15.15	The Politecnico di Torino recruitment strategy	Micaela Demichela for Prof. Laura Montanaro, Vice Rector for the Research
15.15-15.45	Schedule of the meeting	Prof. Micaela Demichela, Re@WBC representative for POLITO

22nd March – Graduated/PhD		
TIME	TOPIC	Reference
10.00 – 11.00	Empowerment for Employability and the Stage and job Unit	Dr. Monica Fassetta, Responsible of the Stage and Job Unit
11.00 – 11.30	Testifies: - E4E program	Serena BOSCA, research fellows at DISAT
11.30-13.00	The Technology Transfer Office	Dott. Shiva LOCCISANO, TTO
13-14:30	Lunch	
14.30- 16.00	The PhD School (SCUDO) and the measures for the employability of PhDs	Irene Gino, Chiara Lauritano, SCUDO
	An experience of PhD in apprenticeship	Andrea ASCHERI, PhD student



ERASMUS+ PROJECT  
**Re@WBC**

Enhancement of HE research potential  
contributing to further growth of the WB region



Co-funded by the  
Erasmus+ Programme  
of the European Union

23rd March – Phd		
TIME	TOPIC	Reference
10.00 -11.30	iThenticate and Turnitin	Mr. Goa Borrek, Turnitin
11.30 - 13	The importance of HR Strategy for Researchers for inclusion of WBC research institutions in European Research Area. Role of ReWBC project in development of HR Strategy for Researchers.	Prof. Dr Miroslav Trajanovic, University of Nis, Serbia
12.15-12.35	Project progress report	Prof. Dr Dragana Cvetkovic Ilić, University of Nis, Serbia
12.35-13.00	Project finance and financial reporting	Dr Saša Nikolić, Assist. Professor, University of Nis, Serbia
13-14:30	Lunch	
14.30 – 16.00	The HRS4R at Politecnico di Torino	Dr. Chiara Biglia, Head of Excellent Science and Researcher Mobility Office

A joint dinner has been organised for the 23rd evening to the “La Capannina” restaurant, near Politecnico.

24th March – Research personnel		
TIME	TOPIC – How to attract international researchers	Reference
10.00-13.00	How to enhance the internationalization of the scientific community: <ul style="list-style-type: none"> <li>- attract international researchers,</li> <li>- promote researchers mobility,</li> <li>- assist researchers stay in Torino</li> </ul>	Internationalization Area (INTE): Silvia VACCA Marco BONINO Marco MASSARO Patrizia PERLO Marina RABAGLIATI Augusta ROUX
13-14:30	Lunch	
14.30-16.00	I3P - the Innovative Enterprise Incubator of the Politecnico of Torino	Ing. Mario VITTONI, I3P

25th March – P2P meetings		
TIME	TOPIC	Reference
10.00-12.00	Scheduled meeting person to persons	Micaela Demichela – Eleonora Pilone for the organization
13-14:30	Lunch	



ERASMUS+ PROJECT

Re@WBC

Enhancement of HE research potential  
contributing to further growth of the WB region



Co-funded by the  
Erasmus+ Programme  
of the European Union

## How to reach Politecnico

	<b>FROM THE AIRPORT</b> 1) Taxi services: <i>Pronto Taxi</i> tel. +39 011 5737 or <i>Radio Taxi</i> tel. +39 011 5730 2) SADEM autobus (link <a href="http://www.aeroportoditorino.it/it/tomove/trasporti-e-parcheggi/in-bus">http://www.aeroportoditorino.it/it/tomove/trasporti-e-parcheggi/in-bus</a> ), stop in front of Porta Susa railway station.
	<b>FROM THE RAILWAY STATIONS</b> 1) From Porta Nuova railway station: cross the boulevard in front of the station (Corso Vittorio Emanuele), go to the bus stop n.40 "Porta Nuova", take the autobus no. 33 and get off at bus stop no. 376 "Politecnico" 2) From Porta Susa railway station: please exit from Gate D, piazza XVIII dicembre. Go to the bus stop no. 27 "XVIII dicembre" and take tram 10 (terminus Settembrini". Take off at bus stop no. 376 "Politecnico" Bus tickets could be found inside or outside the stations at kiosks and tobacconist shops.
	<b>BY BUS:</b> The main entrance to Politecnico is in front of the bus stop no. 27 "Politecnico", where tram 10 and buses 33 and 58 stops. To know in detail Turin transports map please consult the following links: <a href="http://www.gtt.to.it/cms/risorse/urbana/mappa/mapparete.pdf">www.gtt.to.it/cms/risorse/urbana/mappa/mapparete.pdf</a> <a href="http://www.gtt.to.it/cms/risorse/urbana/mappa/zona_centro.pdf">www.gtt.to.it/cms/risorse/urbana/mappa/zona_centro.pdf</a>